

BC109-BH5

# DOLPHIN ELEGANCE HAIR DRYER

---

INSTALL DIAGRAM



## SAFETY WARNINGS

**Read these instructions carefully before installation and use.**

### SAFETY WARNINGS

- › Before use, the appliance must be fitted and properly installed by a qualified electrician.
- › Only connect the appliance to an alternate current power supply, and make sure that the mains voltage corresponds to the one indicated on the appliance.
- 
  - › This hairdryer must be installed out of reach of persons using the bath or shower. Always comply with the requirements of current electrical system regulations.
- › Make sure that the air inlet grills at the bottom of the appliance are never obstructed.
- › Do not use the appliance if any malfunction is noted or if the power cable is damaged in any way.
- › If the power cable is damaged, it must only be replaced by a qualified technician, so as to avoid all risk.
- › Never attempt to repair electrical appliances yourself, but always contact a qualified technician.
- › The elements used to pack the appliance (plastic bags, cardboard box, etc ...) must not be left within reach of small children, as they are a potential source of danger.
- › This appliance must only be used for the purposes for which it has been specifically designed: to dry hair (operate and recharge electric razors, max 20VA). Any other use is to be considered improper and therefore dangerous. The manufacturer will not be considered liable for any damage deriving from improper or incorrect use of the appliance.

- › Always warn children of the dangers of electrical appliances, and of the safety precautions that must be taken. Never leave electrical appliances within reach of children.
- › This appliance is not intended for use by persons (including children) with reduced physical, sensory or mental capabilities, or lack of experience and knowledge, unless they have been given supervision or instruction concerning use of the appliance by a person responsible for their safety.
- › Children should be supervised to ensure that they do not play with the appliance.

### IMPORTANT

This appliance complies with safety requirements for electrical equipment.

**This hairdryer is fitted with a safety thermostat. It will stop automatically if it overheats. Alter a short time it will start up again.**

**Before use, make sure that the appliance air inlet grills are perfectly clean.**

The manufacturer will not be considered liable for any damage to persons or property deriving from failure to comply with the above recommendations, or improper use of the hairdryer. This appliance conforms to European Directives 2004/108/EC, 2009/125/EC, 2006/95/EC and Regulation (EC) No. 1275/2008.

# INSTRUCTIONS

## INSTRUCTIONS FOR USE

To start the hairdryer, remove the handpiece from its housing. Fitted with 110-120V and 220-240V, 50/60 Hz- shaver sockets.

These sockets, which can be accessed by lifting a special protection flap (fig. 6), must only be used to run or recharge electric shavers (max 20VA).

**IMPORTANT:** never connect other appliances such as electric coffee machines, heaters, etc. to these sockets. They are fitted with an electric timer which turns the appliance off automatically after a pre-set time (8 min.). To turn it back on again, simply replace the handpiece in its housing and then remove it again.

## CLEANING AND MAINTENANCE

Plastic components must be cleaned using a cloth damped in warm water.

**WARNING:** do not use abrasive products or chemical detergents. A slight yellowing of the flexible hose after a few months of use is normal and will not impair operation of the appliance.

## INSTRUCTIONS FOR INSTALLATION

**WARNING:** this operation must be carried out by a qualified technician.

Check that the local power supply corresponds with the one indicated on the rating plate.

The power supply network to which the appliance is connected must be fitted with a omnipolarebeli switch. To guarantee additional protection it is recommended that the power supply system feeding the appliance be fitted with a differential switch with a trip current not exceeding 30 mA. For further information, please contact your electrician.

**The appliance is destined for assembly and installation on a wall only (vertical). The correct direction of installation is with the extending pipe outlet at the bottom.**

This hairdryer is an approved product with protection degree IP24 (EN60529). For installation specifications, please refer to national regulations on the use and installation of appliances with IP24 protection from splashing. If the power cable with plug fitted to the appliance is used, the power socket to which it is connected must be out of reach of possible water splashes.

## MOUNTING SEQUENCE

1. After establishing the position in which the appliance is to be installed, drill 3 holes  $\varnothing$  6 mm in the wall as shown in fig. 1.
2. Dismantle the "T" bracket from the back of the appliance, as shown in figure 2.
3. If the appliance is to be connected directly to the power supply, the power cable fitted to the hairdryer must be disconnected. When installing in this way it is necessary to provide an all-polar disconnection switch with a contact opening  $\geq$  3mm upstream of the appliance. Pass the cables from the mains through one of the two holes "A" or "B" in the "T" bracket and fix them to the terminal (fig.3). (Land N)
4. Fix the "T" bracket to the wall using the screws and plugs provided (fig. 4).
5. Hang the appliance on the "T" bracket and fix it at the bottom using the screw provided (fig. 5).

## GUARANTEE

See Dolphin's warranty page on the website: <https://www.dolphinsolutions.co.uk/dolphin-warranty/>

# INSTALLATION FIGURES

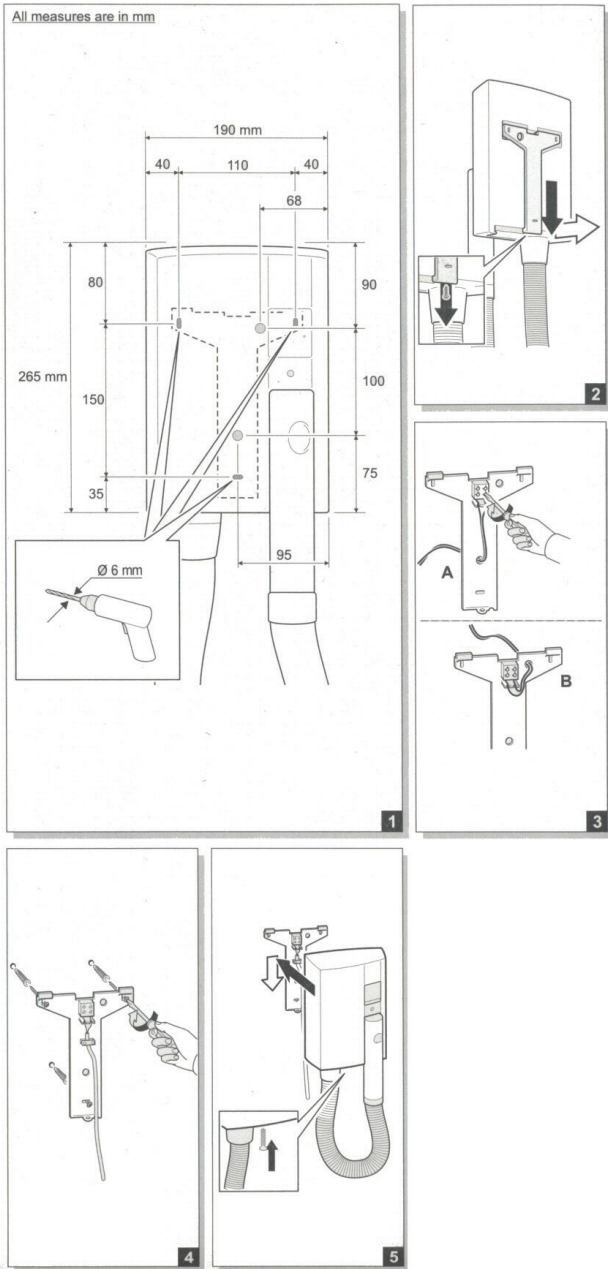



**Dolphin Solutions Ltd**

Southpoint, Compass Park, Bodiam,  
Robertsbridge, TN32 5BS

Tel: +44 (0)1424 20 22 24

Fax: +44 (0)1424 205 200

[info@dolphinsolutions.co.uk](mailto:info@dolphinsolutions.co.uk)

[www.dolphinsolutions.co.uk](http://www.dolphinsolutions.co.uk)